

South Carolina,

Greenville County.

By the request of Frank & W.T. Berry I have surveyed the above piece of land and find it to contain forty-six and $\frac{3}{4}$ acres known in the division as Tract No. 3 and it hath such shape, marks, and boundaries as the above plat represents.
 Surveyed Aug. 9th, 1910.

By W.A. Hester, Surveyor. Recorded

and copied by Jas. R. Bates.

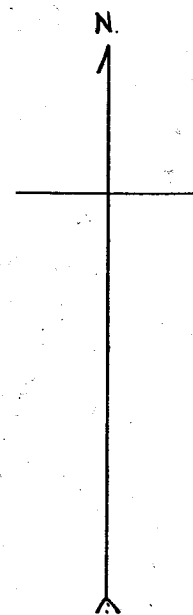
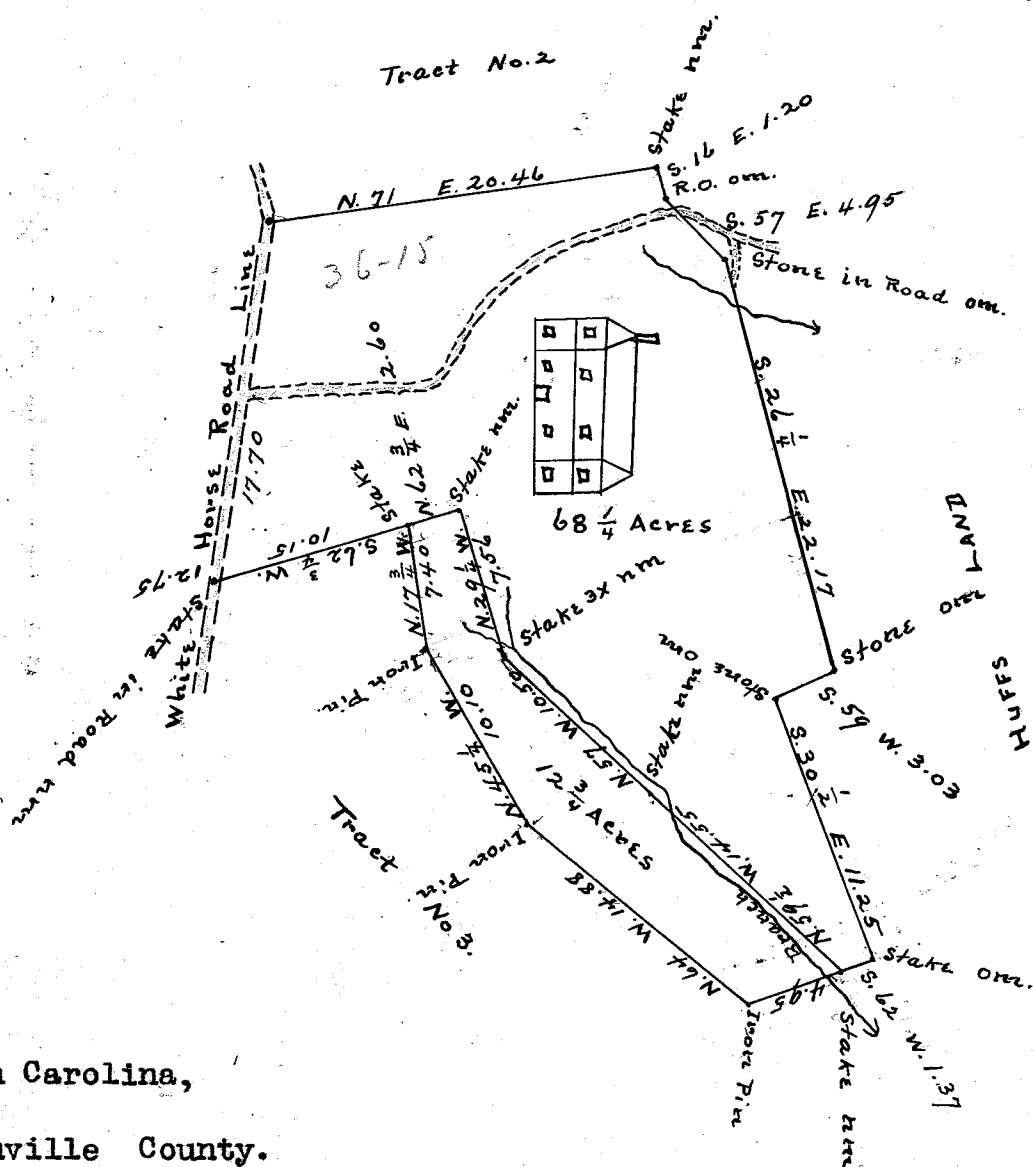
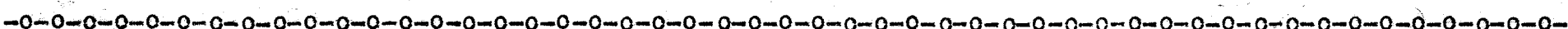

South Carolina,

Greenville County.

By the request of Frank & W.T. Berry I have surveyed the above piece of land and find it to contain (68- $\frac{1}{4}$) sixty-eight and a fourth acres., known in the division as Tract No. 1, (the Home Place) and it hath such shape, marks and boundaries as the above plat represents.
 Surveyed Aug. 9th, 1910.

by W.A. Hester, Surveyor Recorded

and copied by Jas. R. Bates.

Handwritten calculation:
 19
 66) 1200
 66
 540
 594

Handwritten calculation:
 12.10
 66060
 60600
 66660